



# TGM INTERNATIONAL

**Manufacturer, Supplier of Jig and Fixtures, Receiver Gauges, Attribute Gauges, Drill Jig Bushes, Work holding Devices & Equipment's, Parallel Keys, Machined Components for all industry.**

## Jig & Fixture

**(Design & Mfg. of Mechanical | Pneumatic & Hydraulic)**

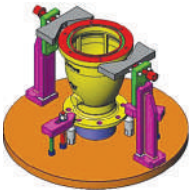
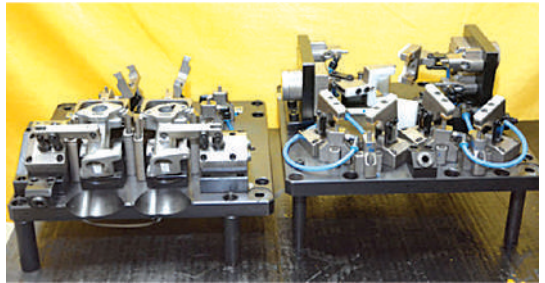
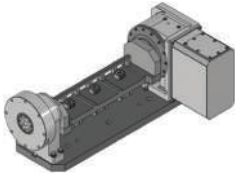

- All type Jigs
- Fixture for Turning, VMC ,VTL ,HMC
- 4<sup>th</sup> axis Fixture
- Testing fixture etc..

## Attribute Gauges

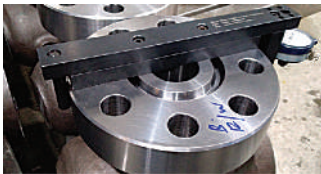

- Plug Gauges (Steel / Carbide)
- Snap Gauges
- Receiver Gauges
- GD & T Functional Gauges
- Beam Gauges
- Special Gauges for Inspection

## Machined Parts & Spares for all industries



- Ferrous & Non Ferrous Machined Parts
- Reverse Engineering Parts • Spares

## Work Holding Devices & Equipment's

- Stud
- Nuts
- Forged Bolt
- Clamps
- Washers
- Screw Jacks etc.



## Parallel Keys

- Parallel Keys
- Pump shaft Keys
- DIN6885 all type Keys
- Material : Alloys steels & Stainless steels



## Drill Jig Bushes

- Plain Bushes
- Headed & Headless Bush
- Renewable Bush
- Liner Bushes etc.



 9952529181 / 9629544041

 [tgmindia2016@gmail.com](mailto:tgmindia2016@gmail.com)  
[info@tgminternational.in](mailto:info@tgminternational.in)

 [tgmexports.com](http://tgmexports.com)  
[tgminternational.in](http://tgminternational.in)

## TGM INTERNATIONAL

Office & Factory  
S.F. No. 20/1D, Eachanari Road,  
Kurumbapalayam Pirivu, Madukkarai Post,  
Coimbatore - 641 105. Tamilnadu